

Installation Instructions for Wilson Partitions 225 Demountable Wall System

Door Frame w/ Attached Sidelight

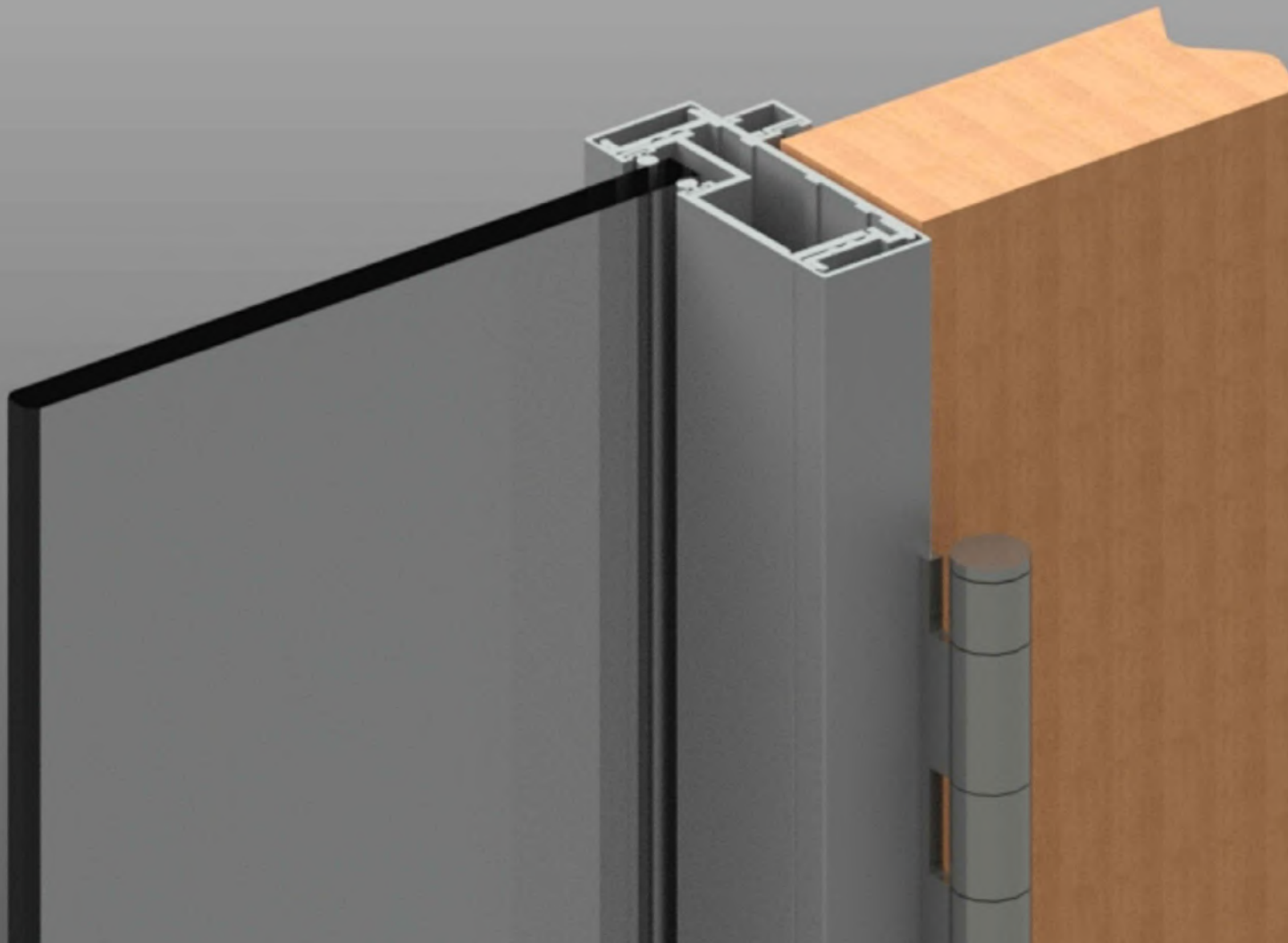

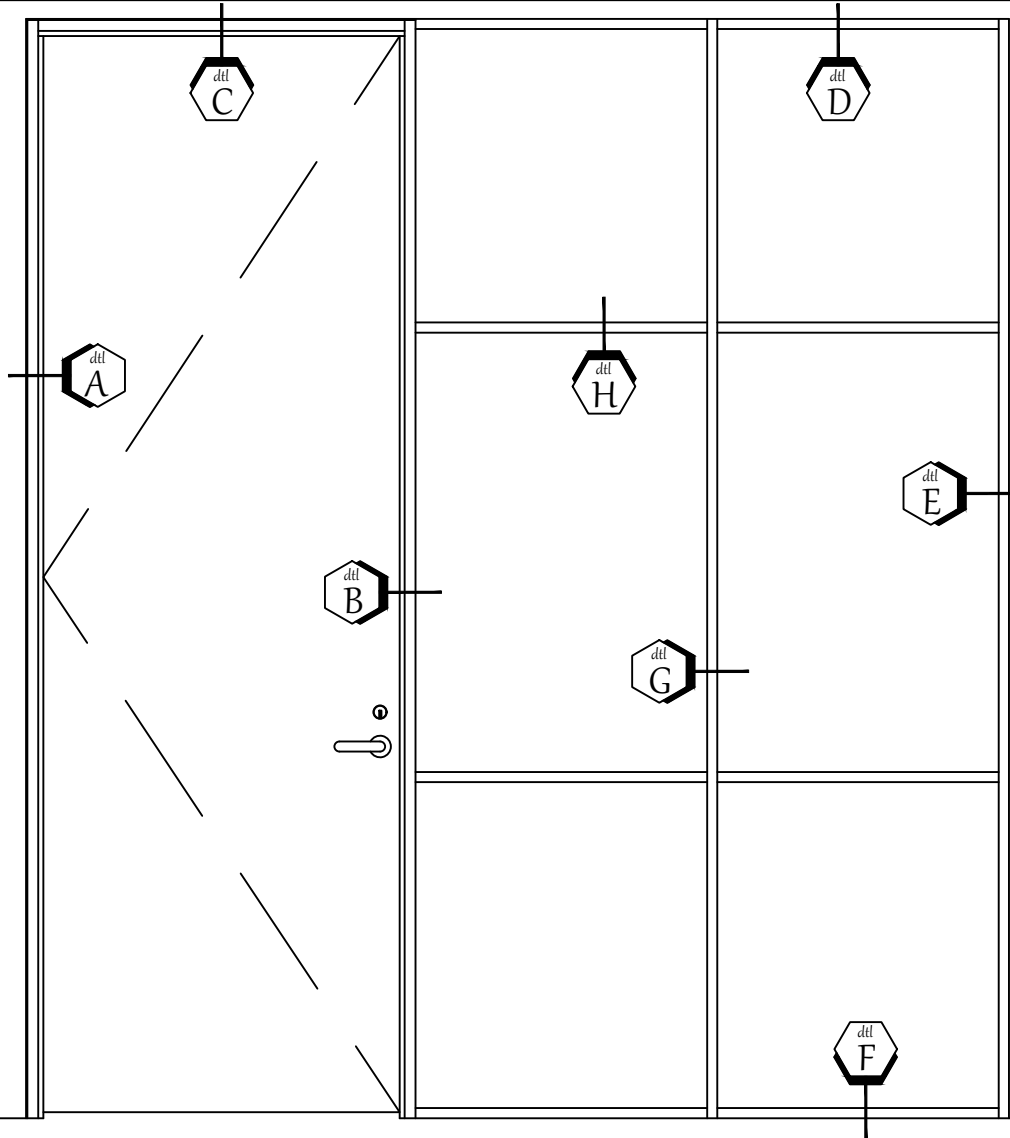

Basic Product Details

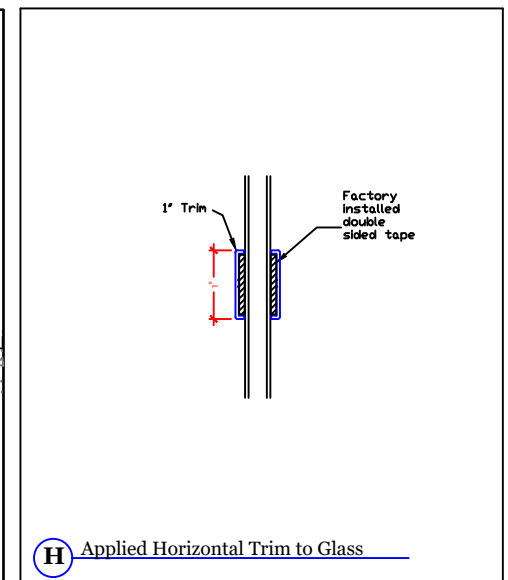
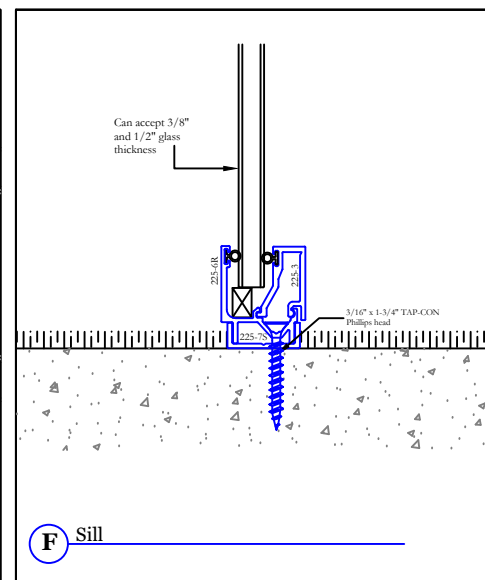
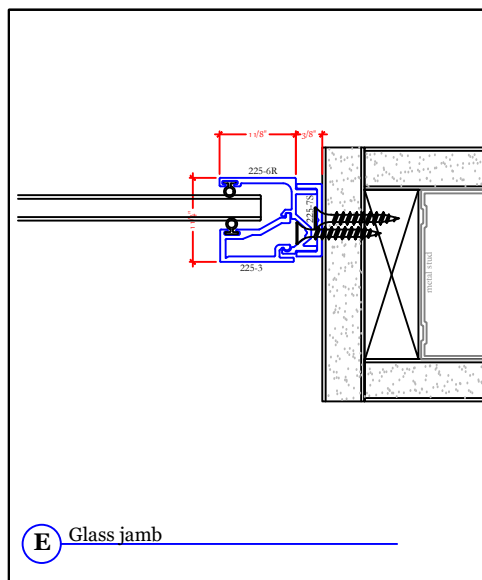
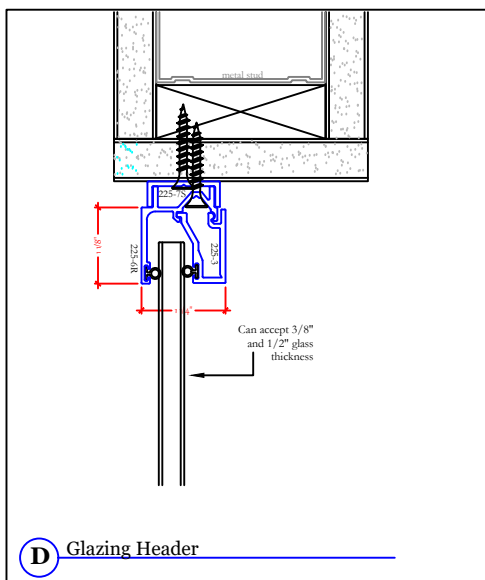
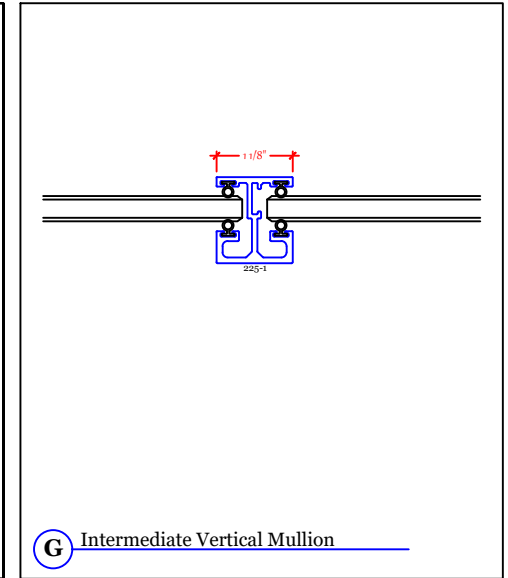
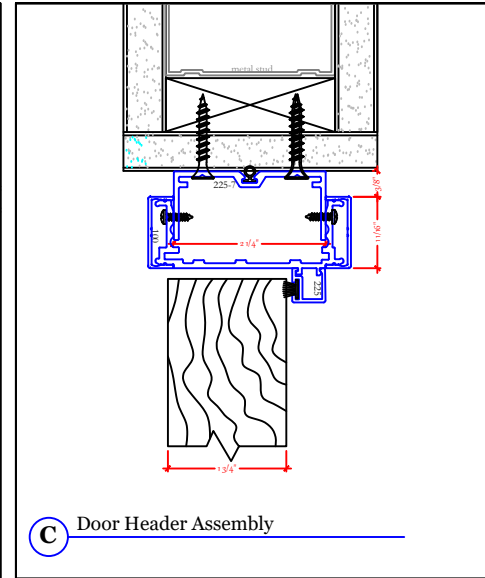
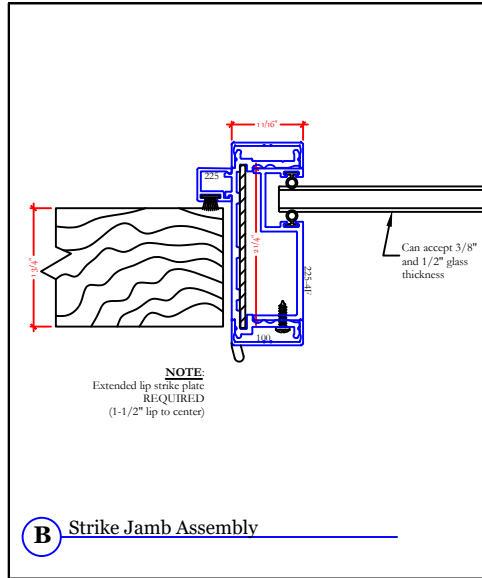
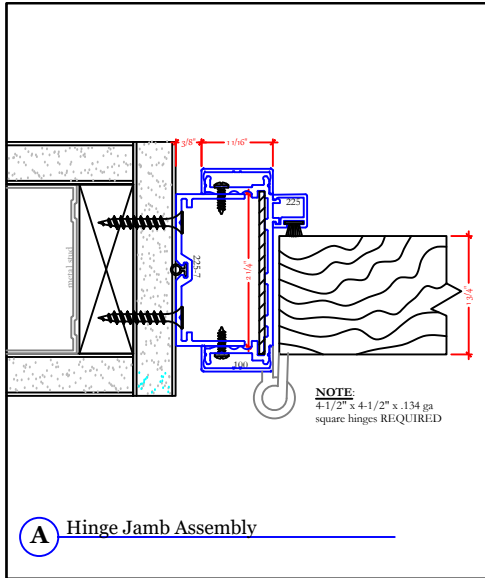

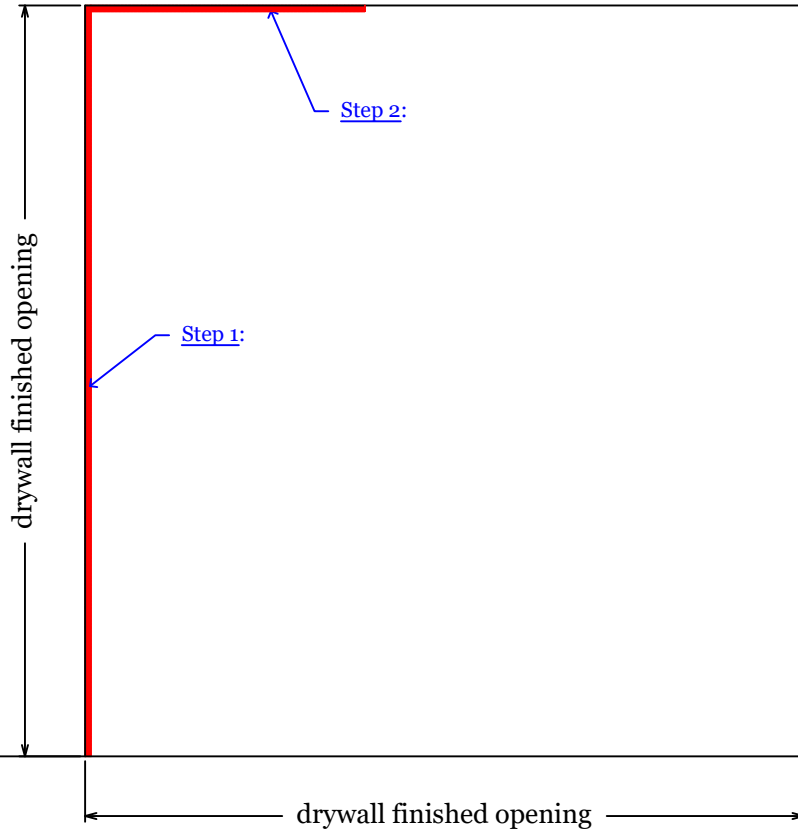

Step 1:
Install wall start from floor to ceiling.

Step 2:
Install the wall start above the door frame header ONLY (part is cut at the factory to the exact length - do not trim)

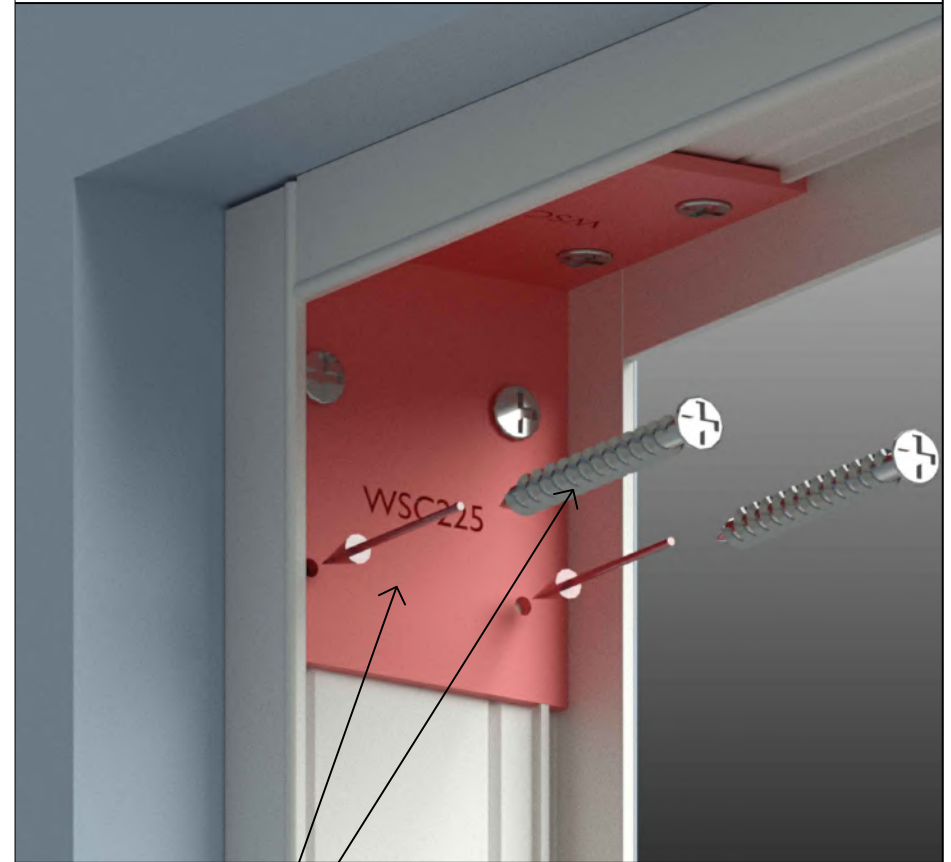

Attach wall start to drywall opening with the WSC225 clip using 1-1/4" drywall screws
Finish securing the wall start to the drywall openings using 1-1/4" drywall screws at ~ 20" o.c.

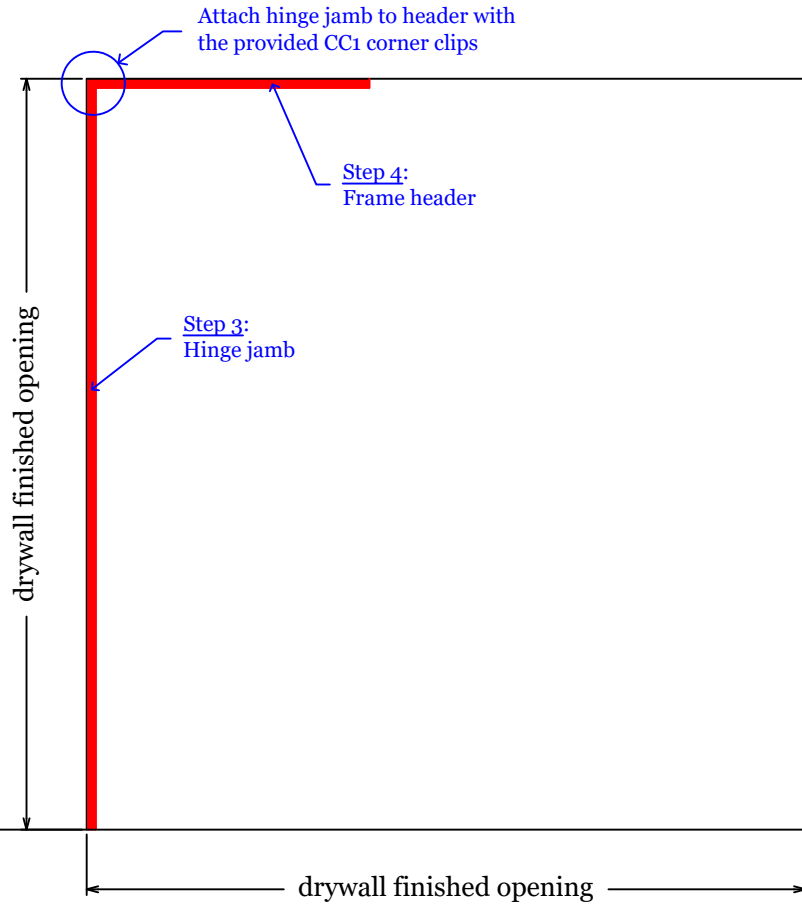

Step 3:
Install the hinge jamb over the wall start holding a $\frac{3}{16}$ " gap.

Step 4:
Install the door frame header over the wall start holding a $\frac{3}{16}$ " gap.
Attached the provided CC1 corner clips on each side.



The frame at drywall locations should engage to the 1st notch ... this will hold the frame at the proper depth for trim installation

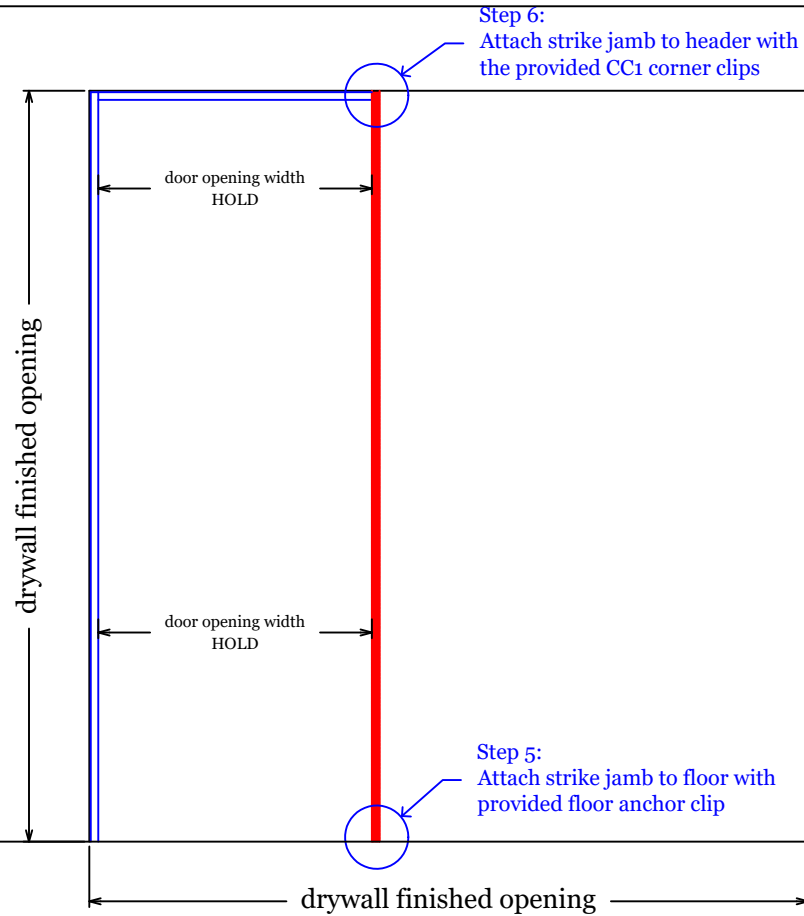

Step 5:
Install the strike jamb using the provided floor clip ... Make sure to hold the door opening width... Secure the floor clip to the strike jamb and floor using the provided anchors..

Step 6:
Install the flush glass pocket insert into the strike jamb from floor to ceiling Keep in mind the insert will extend past the top of the strike jamb.. Attached the strike jamb to the header with the provided CC1 clip on each side.

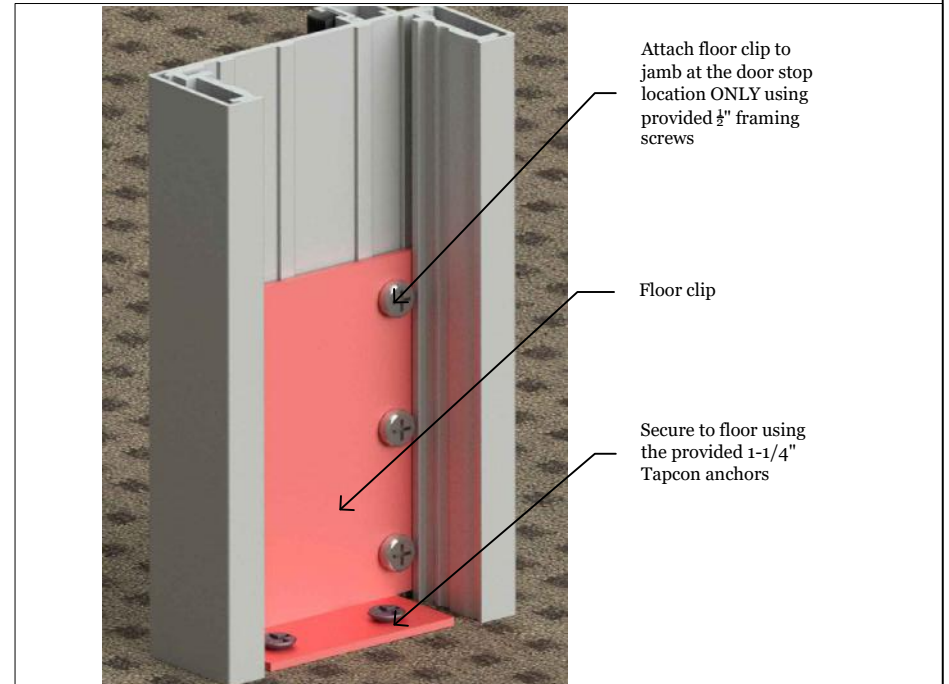

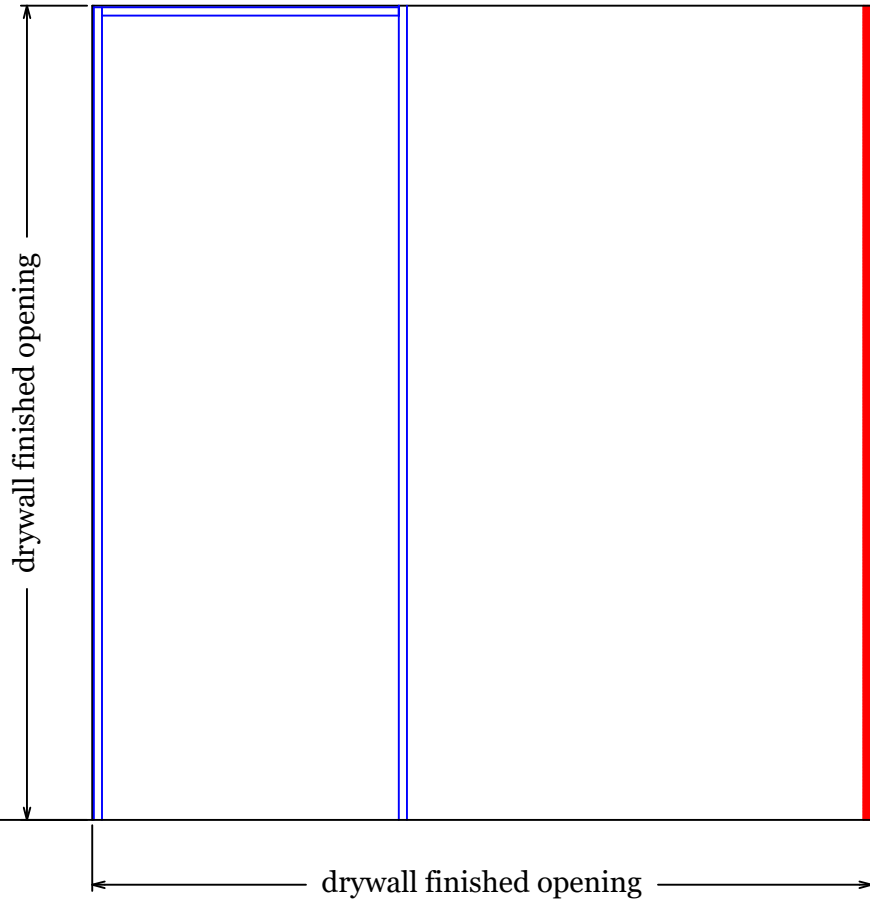

Step 7:
Install the vertical glass pocket into the strike jamb and the vertical glass jamb on the opposite wall

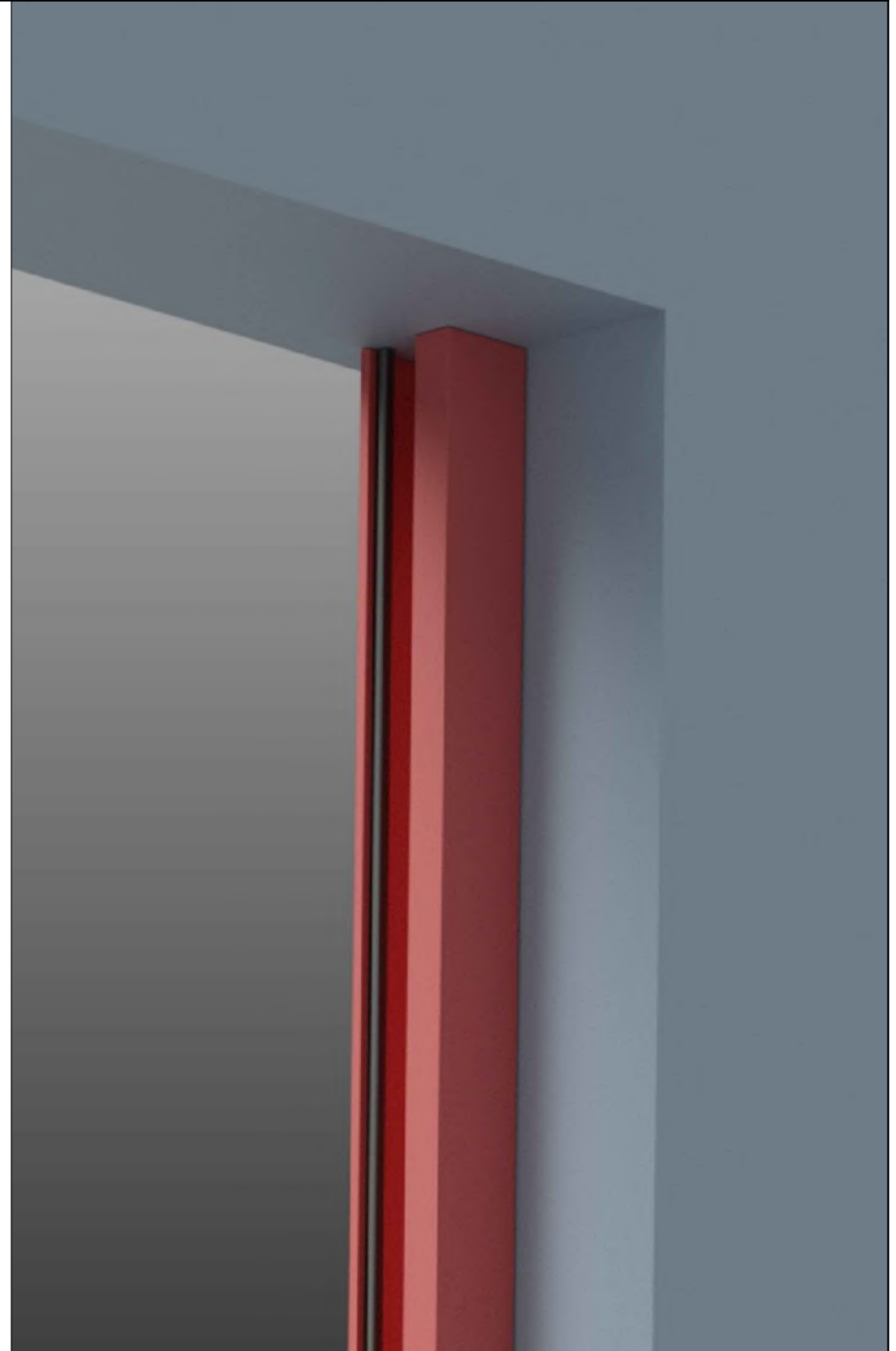

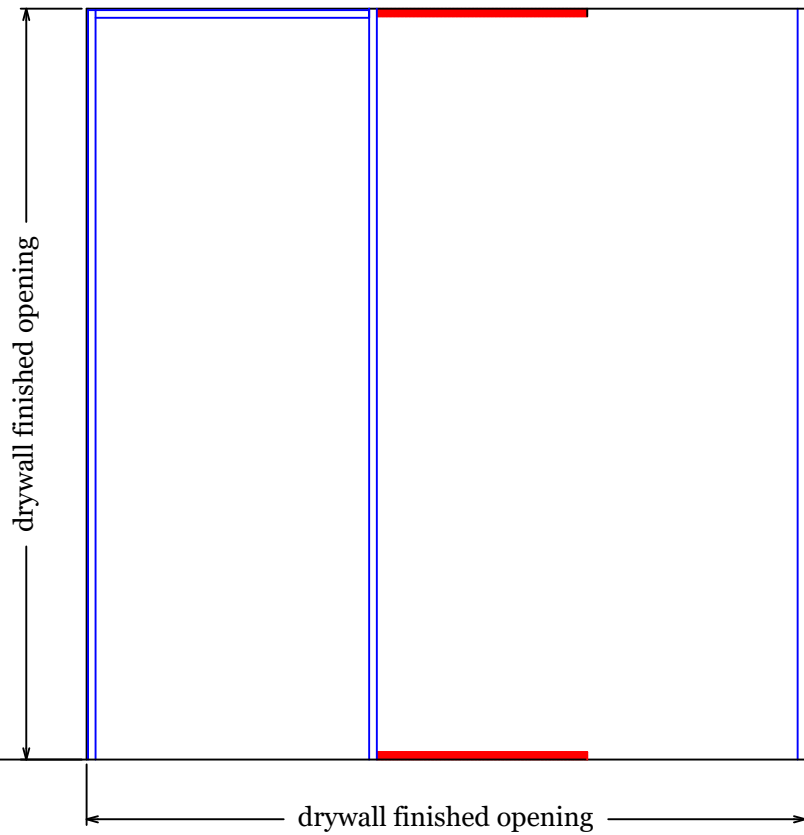

Step 8:

Determine the length of the horizontal glass mullions and cut one side (top and bottom) and secure to the ceiling with 1-5/8" drywall screws and to the floor with the provided 1-1/4" x 3/16" TapCons - Phillips head.



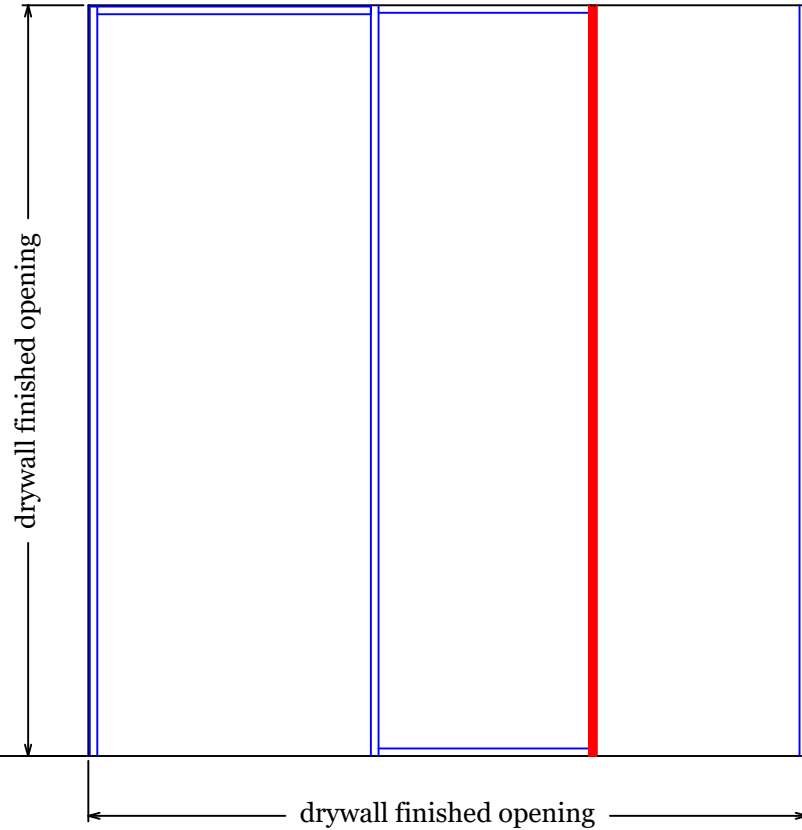

Step 9:

Cut the vertical intermediate glass jamb to length (floor to ceiling).
Install with 1-5/8" drywall screws to ceiling.
(Note that the screw will go in at an angle)
The bottom will be secured by the installation of the glass.

(Use a small bar clamp to hold the vertical in place while drilling and securing to the ceiling)



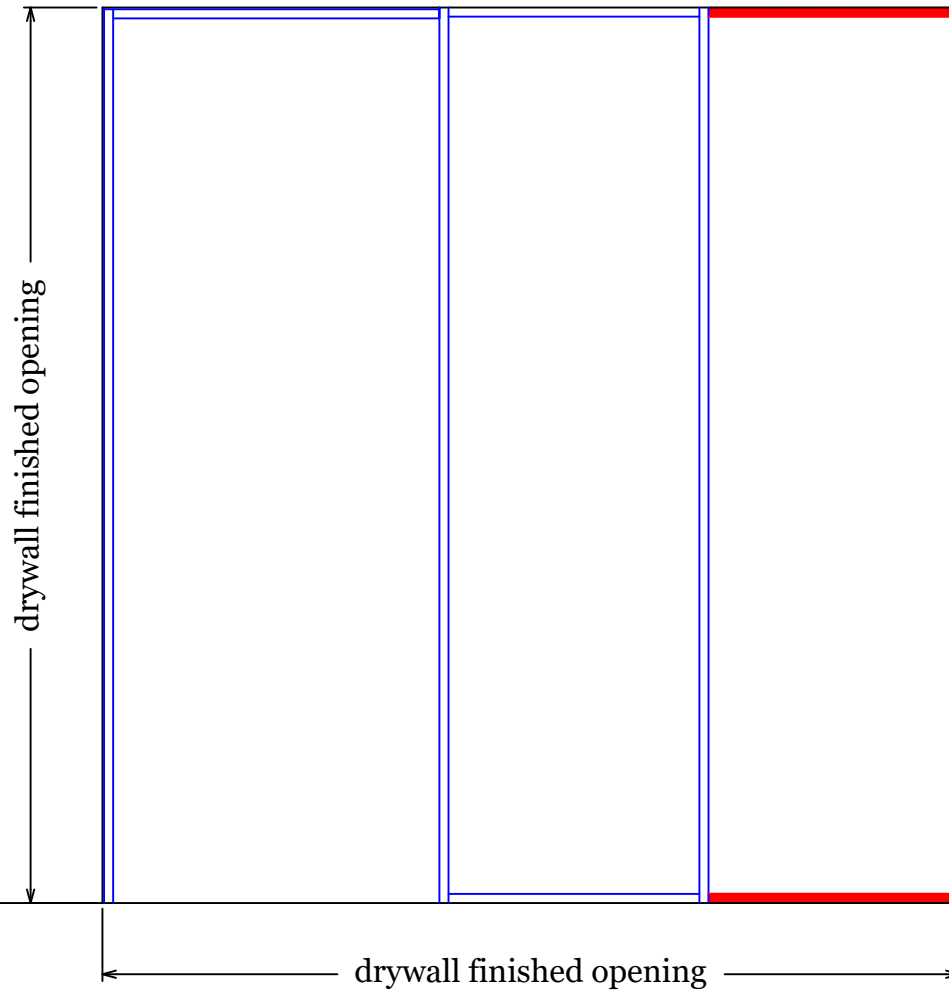

Step 10:

Determine the length of the remaining horizontal glass mullions and cut one side (top and bottom) and secure to ceiling and floor.

If there are additional intermediate vertical mullions, continue to install in a progressive manner.

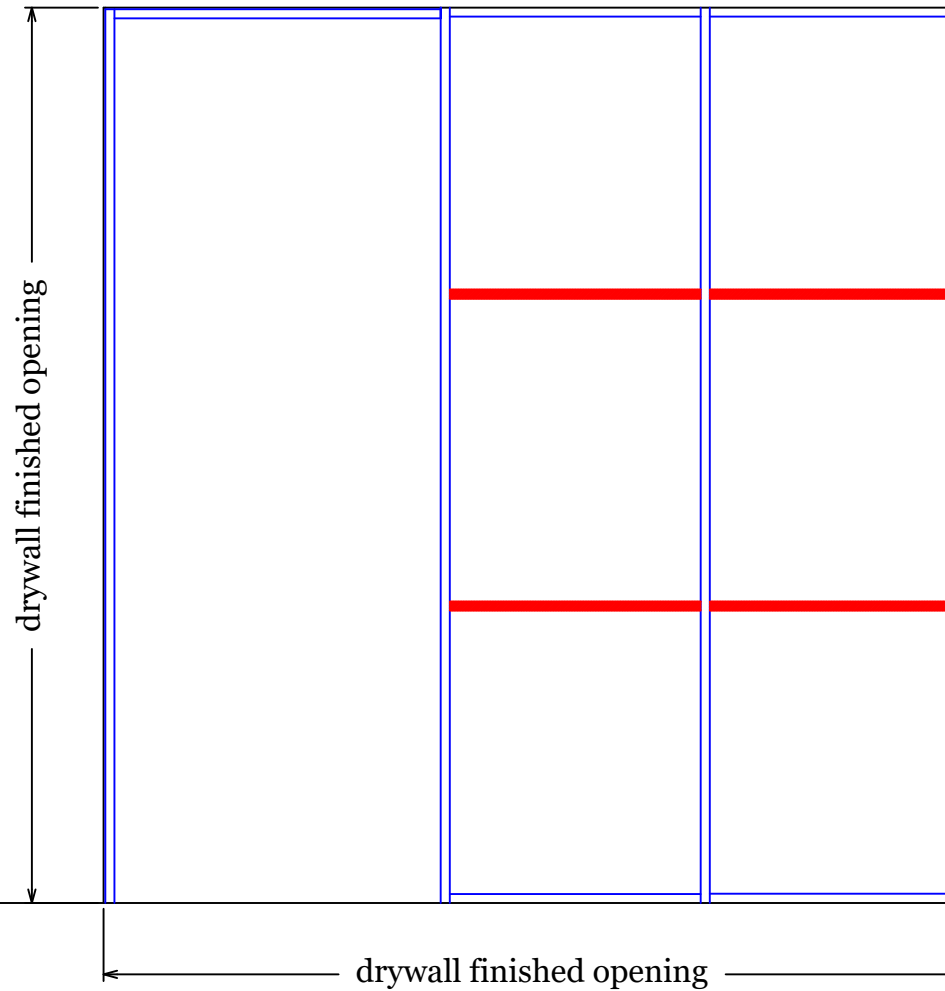

Step 11:

After installation of glass, cut the horizontal trim to length and apply directly to glass on each side. (trim has factory applied double sided tape)