

FINISH _____

- SERIES**
- 2300 (3-3/4" WALL)
 - 2400 (4 7/8" WALL)

- DOOR FRAME SEAL**
- GRAY MOHAIR
 - BLACK MOHAIR

- GLASS THICKNESS**
- 1/4"
 - 3/8"

- GLAZING VINYL**
- GRAY
 - BLACK

DOOR FRAME AND SIDELITE

LH FRAME

QTY. _____

MARK# _____

RH FRAME (OPPOSITE AS SHOWN)

QTY. _____

MARK# _____

SPECIAL INSTRUCTIONS

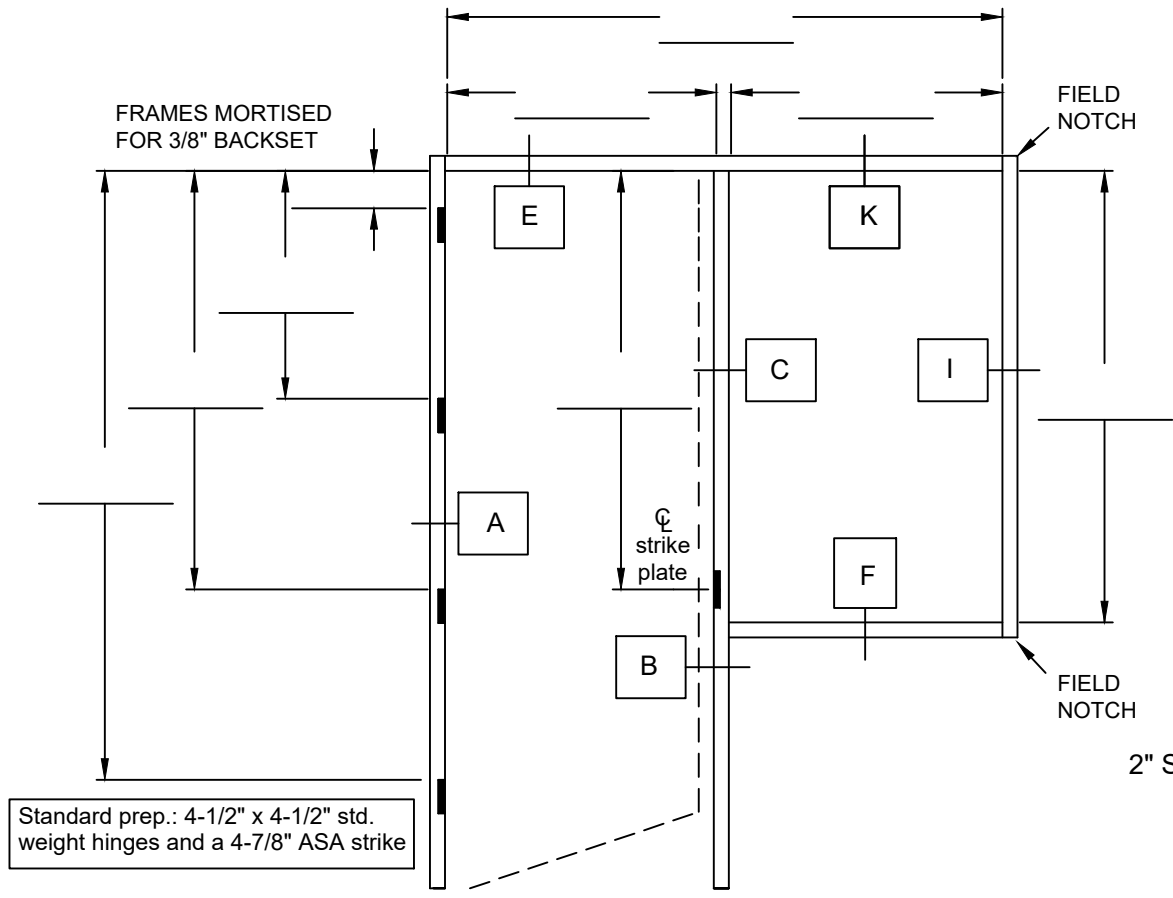

Standard prep.: 4-1/2" x 4-1/2" std. weight hinges and a 4-7/8" ASA strike

- 2" SCRIBE**
- YES
 - NO