

# FINISH \_\_\_\_\_

- SERIES**
- 2300 (3-3/4" WALL)
  - 2400 (4 7/8" WALL)

- DOOR FRAME SEAL**
- GRAY MOHAIR
  - BLACK MOHAIR

- GLASS THICKNESS**
- 1/4"
  - 3/8"

- GLAZING VINYL**
- GRAY
  - BLACK

## DOOR FRAME AND SIDELITE

### LH FRAME

QTY. \_\_\_\_\_

MARK# \_\_\_\_\_

\_\_\_\_\_

\_\_\_\_\_

### RH FRAME (OPPOSITE AS SHOWN)

QTY. \_\_\_\_\_

MARK# \_\_\_\_\_

\_\_\_\_\_

\_\_\_\_\_

**SPECIAL INSTRUCTIONS**

\_\_\_\_\_

\_\_\_\_\_

\_\_\_\_\_

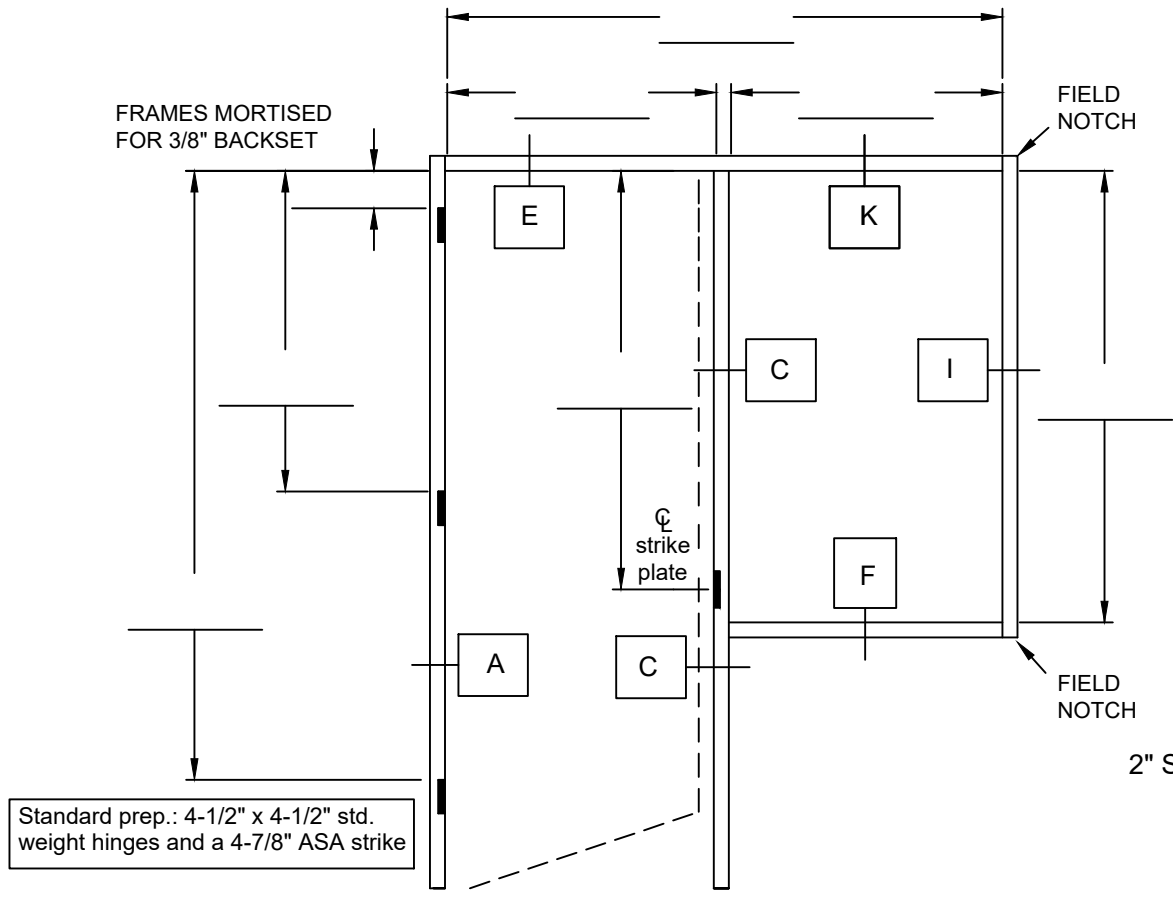

Standard prep.: 4-1/2" x 4-1/2" std. weight hinges and a 4-7/8" ASA strike

- 2" SCRIBE**
- YES
  - NO